

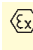





Standard terminal blocks

Screw clamp

 **DIN 1 - 3**

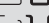
 refer to the section "Special Applications" for part numbers and characteristics.

Test connector : refer to section connectors

End stop		th. 9 mm	BADL	V0	1SNA 399 903 R0200
End stop		th. 10 mm	BAM2	V2	1SNA 206 351 R1600
End stop		th. 10 mm	BAM2 V0	V0	1SNA 296 351 R0000
Rail		35 x 7,5 x 1	PR3.Z2		1SNA 174 300 R1700
Rail		35 x 15 x 2,3	PR4		1SNA 168 500 R1200
Rail		35 x 15 x 1,5	PR5		1SNA 168 700 R2200
Rail		32 x 15 x 1,5	PR1.Z2		1SNA 163 050 R0400

Other end stops, rails and accessories : see section on accessories.

Characteristics

Wire size

		IEC		UL	CSA
		NFC	DIN		
Screw clamp	Rigid	0,2-4 mm ²		24-10 AWG	24-10 AWG
	Flexible	0,22-4 mm ²		24-10 AWG	24-10 AWG

Voltage

Rated	1000 V	600 V	600 V
Impulse withstand	8 kV		
Pollution degree	3		

Current

Rated	32 A	30 A	25 A
-------	------	------	------

Wire size

Rated / Gauge		4 mm ² / A4	10 AWG	10 AWG
Wire strip. length	Recomm. Screwdriver	Recomm. torque	Protection	
9,5 mm	4 mm	0,5-0,8 Nm	IP 20	
.37"	.157"	4.4-7.1 lb.in.	NEMA 1	

Notes

The use of some accessories may decrease the block's voltage rating. For more information, consult us.

BJDP1 permits the interconnection with a terminal block series "M" spacing 16 mm.

BJDP3 permits the interconnection with a terminal block series "M" spacing 12 mm.

BJDP4 permits the interconnection with a terminal block series "D" spacing 8 mm or a terminal block series "M" spacing 8 or 10 mm.

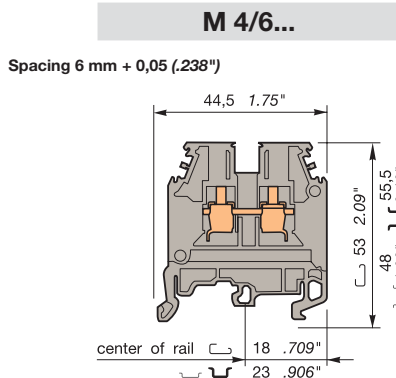

Standard 6 mm block

1SNA 115 116 R0700



Accessories

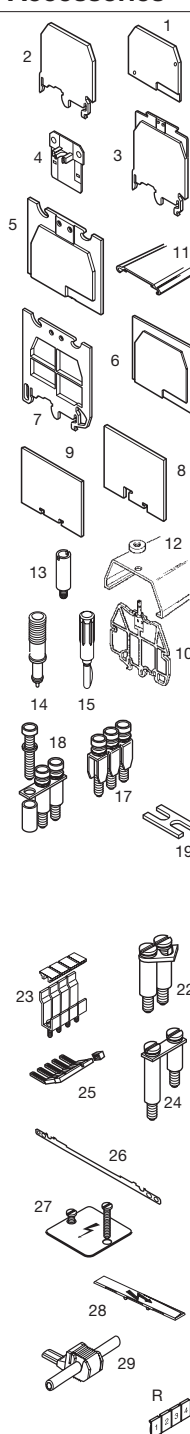

		Type		Part numbers	
1	End section	grey	FEM6	th. 2,8 mm	1SNA 118 368 R1600
		blue	FEM6	th. 2,8 mm	1SNA 128 368 R1000
		orange	FEM6	th. 2,8 mm	1SNA 103 126 R1600
		yellow	FEM6	th. 2,8 mm	1SNA 103 062 R2100
		green	FEM6	th. 2,8 mm	1SNA 103 125 R1500
		white	FEM6	th. 2,8 mm	1SNA 103 312 R2000
		beige	FEM6 V0	th. 2,8 mm	1SNA 198 368 R1700
		black	FEM6	th. 2,8 mm	1SNA 107 005 R2500
	2 End section	grey	FEM61 (3)	th. 3,0 mm	1SNA 114 776 R2300
	3 End section	grey	FEM6C (3)	th. 3,0 mm	1SNA 114 777 R2400
	4 Circuit separator	grey	SCM6		1SNA 113 003 R1000
		blue	SCM6		1SNA 123 003 R1200
		beige	SCM6 V0	V0	1SNA 193 003 R1100
	5 Separator end section	grey	SCF6	th. 3,0 mm	1SNA 118 707 R0300
		blue	SCF6	th. 3,0 mm	1SNA 128 707 R0500
		beige	SCF6 V0	V0	1SNA 198 707 R0400
6	Separator end section	grey	SCF61	th. 3,0 mm	1SNA 114 202 R2500
	7 Separator end section	grey	SCFM6 (3)	th. 3,0 mm	1SNA 114 825 R0500
	8 Separator end section	grey	SCFEX1 (3)	th. 2,4 mm	1SNA 103 619 R0400
	9 Separator end section	grey	SCFEX3 (3)	th. 2,4 mm	1SNA 103 620 R0100
	10 Separator end section (for cover CPV)	grey	SCFCV1-2 (3)	th. 3,0 mm	1SNA 116 795 R1100
		beige	SCFCV1-2 V0(3)V0	th. 3,0 mm	1SNA 196 795 R1200
	11 Protective cover		CPM (for FEM6C, SCF6(V0) and SCFM6)		1SNA 187 312 R1400
	12 Protective cover		CPV1-2 (for SCFCV1-2-...)		1SNA 176 816 R1200
	13 Test socket		AL2 (1)	DIA. 2 mm	1SNA 163 043 R2100
			AL3 (1)	DIA. 3 mm	1SNA 163 261 R0000
	14 Test device		DCJ	yellow	1SNA 173 059 R0300
	15 Test plug		FC2	DIA. 2 mm	1SNA 007 865 R2600
			FC4	DIA. 4 mm	1SNA 167 860 R0100
17	Assembled jumper bar (with IP20 protection)	32 A	BJMI6 (1)	2 poles	1SNA 176 663 R0000
		32 A	BJMI6 (1)	3 poles	1SNA 176 664 R0100
		32 A	BJMI6 (1)	4 poles	1SNA 176 665 R0200
		32 A	BJMI6 (1)	5 poles	1SNA 176 666 R0300
		32 A	BJMI6 (1)	10 poles	1SNA 176 667 R0400
		32 A	BJS6 (1)	20 poles	1SNA 174 784 R2000
			EV6I		1SNA 206 394 R0200
	19 Connector plate	35 A	EL6		1SNA 173 627 R2100
22	Pivoting jumper bar	35 A	BJP6 (1)		1SNA 174 413 R1400
	23 Alternated jumper bar	35 A	BJA6 (1)	10 poles	1SNA 116 541 R1200
	24 Universal jumper bar	50 A	BJDP1 (1)(2) spacing 6 <-> spacing 16		1SNA 179 623 R0300
		70 A	BJDP3 (1)(2) spacing 6 <-> spacing 12		1SNA 179 625 R0500
		50 A	BJDP4 (1)(2) spacing 6 <-> spacing 8 or 10		1SNA 174 781 R2500
	25 Comb-type jumper bar	35 A	PC6 (4)	2 poles	1SNA 113 546 R1400
		35 A	PC6 (4)	10 poles	1SNA 113 548 R2600
			EIP		1SNA 113 550 R2400
	Insulating tip		CBM5	th. 0,5 mm	1SNA 178 745 R1400
	26 Shield connector		CBM8	th. 0,8 mm	1SNA 178 746 R1500
	27 Protection label		EP6	4 blocks	1SNA 163 427 R1700
	Screw for protection label		VSP6		1SNA 163 433 R1500
	28 Protection label		EPU6		1SNA 107 038 R2500
	29 IDC jumper		AD2,5		1SNA 114 205 R2000

R See section on markers marking method

RC65 - RC610 RCT610

Note : (1) A circuit separator SC may be required with the use of these accessories.
(2) See "Notes". (3) End sections and separators snapped on rails.
(4) See section : "Accessories" for other configurations of poles.

M 4/6.T	M 4/6.1	M 4/6.2	M 4/6.3	M 4/6.4	M 4/6.C	
Spacing 6 mm + 0,05 (.238")	Spacing 6 mm + 0,05 (.238")	Spacing 6 mm + 0,05 (.238")	Spacing 6 mm + 0,05 (.238")	Spacing 6 mm + 0,05 (.238")	Spacing 6 mm + 0,05 (.238")	
Grey □ 1SNA 115 224 R1300 Beige V0 □ 1SNA 195 224 R1400	Grey □ 1SNA 115 259 R0600 Beige V0 □ 1SNA 195 259 R0700 Orange □ 1SNA 105 208 R1300	Grey □ 1SNA 115 217 R1400 Beige V0 □ 1SNA 195 217 R1500	Grey □ 1SNA 115 268 R0700 Beige V0 □ 1SNA 195 268 R0000	Grey □ 1SNA 115 192 R0400 Beige V0 □ 1SNA 195 192 R0500	Grey □ 1SNA 115 208 R0400 Beige V0 □ 1SNA 195 208 R0500	
M 4/6 with 1 test socket screw DIA. 2 mm/.079" on the right	M 4/6 with partition	M 4/6.1 equipped with a test socket DIA. 2 mm/.079"	M 4/6.1 equipped with a test socket DIA. 3 mm/.12"	M 4/6.1 equipped with a test socket DIA. 4 mm/.16"	M 4/6.1 equipped with a test socket DIA. 2,5 mm/.10" for connector	
UL	CE	UL	CE	UL	CE	
Part numbers	Part numbers	Part numbers	Part numbers	Part numbers	Part numbers	Part numbers
1SNA 118 368 R1600 1SNA 128 368 R1000 1SNA 103 126 R1600 1SNA 103 062 R2100 1SNA 103 125 R1500 1SNA 103 312 R2000 V0 1SNA 198 368 R1700 1SNA 107 005 R2500 (3) 1SNA 114 776 R2300 (3) 1SNA 114 777 R2400 1SNA 113 003 R1000 1SNA 123 003 R1200 V0 1SNA 193 003 R1100 1SNA 118 707 R0300 1SNA 128 707 R0500 V0 1SNA 198 707 R0400 1SNA 114 202 R2500 (3) 1SNA 114 825 R0500 (3) 1SNA 103 619 R0400 (3) 1SNA 103 620 R0100 (3) 1SNA 116 795 R1100 (3)V0 1SNA 196 795 R1200 1SNA 187 312 R1400 1SNA 176 816 R1200	1SNA 118 368 R1600 1SNA 128 368 R1000 1SNA 103 126 R1600 1SNA 103 062 R2100 1SNA 103 125 R1500 1SNA 103 312 R2000 V0 1SNA 198 368 R1700 1SNA 107 005 R2500 (3) 1SNA 114 776 R2300 (3) 1SNA 114 777 R2400 1SNA 113 003 R1000 1SNA 123 003 R1200 V0 1SNA 193 003 R1100 1SNA 118 707 R0300 1SNA 128 707 R0500 V0 1SNA 198 707 R0400 1SNA 114 202 R2500 (3) 1SNA 114 825 R0500 (3) 1SNA 103 619 R0400 (3) 1SNA 103 620 R0100 (3) 1SNA 116 795 R1100 (3)V0 1SNA 196 795 R1200 1SNA 187 312 R1400 1SNA 176 816 R1200 1SNA 163 043 R2100 1SNA 163 261 R0000 1SNA 173 059 R0300 1SNA 007 865 R2600	1SNA 118 368 R1600 1SNA 128 368 R1000 1SNA 103 126 R1600 1SNA 103 062 R2100 1SNA 103 125 R1500 1SNA 103 312 R2000 V0 1SNA 198 368 R1700 1SNA 107 005 R2500 (3) 1SNA 114 776 R2300 (3) 1SNA 114 777 R2400 1SNA 113 003 R1000 1SNA 123 003 R1200 V0 1SNA 193 003 R1100 1SNA 118 707 R0300 1SNA 128 707 R0500 V0 1SNA 198 707 R0400 1SNA 114 202 R2500 (3) 1SNA 114 825 R0500 (3) 1SNA 103 619 R0400 (3) 1SNA 103 620 R0100 (3) 1SNA 116 795 R1100 (3)V0 1SNA 196 795 R1200 1SNA 187 312 R1400 1SNA 176 816 R1200	1SNA 118 368 R1600 1SNA 128 368 R1000 1SNA 103 126 R1600 1SNA 103 062 R2100 1SNA 103 125 R1500 1SNA 103 312 R2000 V0 1SNA 198 368 R1700 1SNA 107 005 R2500 (3) 1SNA 114 776 R2300 (3) 1SNA 114 777 R2400 1SNA 113 003 R1000 1SNA 123 003 R1200 V0 1SNA 193 003 R1100 1SNA 118 707 R0300 1SNA 128 707 R0500 V0 1SNA 198 707 R0400 1SNA 114 202 R2500 (3) 1SNA 114 825 R0500 (3) 1SNA 103 619 R0400 (3) 1SNA 103 620 R0100 (3) 1SNA 116 795 R1100 (3)V0 1SNA 196 795 R1200 1SNA 187 312 R1400 1SNA 176 816 R1200	1SNA 118 368 R1600 1SNA 128 368 R1000 1SNA 103 126 R1600 1SNA 103 062 R2100 1SNA 103 125 R1500 1SNA 103 312 R2000 V0 1SNA 198 368 R1700 1SNA 107 005 R2500 (3) 1SNA 114 776 R2300 (3) 1SNA 114 777 R2400 1SNA 113 003 R1000 1SNA 123 003 R1200 V0 1SNA 193 003 R1100 1SNA 118 707 R0300 1SNA 128 707 R0500 V0 1SNA 198 707 R0400 1SNA 114 202 R2500 (3) 1SNA 114 825 R0500 (3) 1SNA 103 619 R0400 (3) 1SNA 103 620 R0100 (3) 1SNA 116 795 R1100 (3)V0 1SNA 196 795 R1200 1SNA 187 312 R1400 1SNA 176 816 R1200 1SNA 167 860 R0100	1SNA 118 368 R1600 1SNA 128 368 R1000 1SNA 103 126 R1600 1SNA 103 062 R2100 1SNA 103 125 R1500 1SNA 103 312 R2000 V0 1SNA 198 368 R1700 1SNA 107 005 R2500 (3) 1SNA 114 776 R2300 (3) 1SNA 114 777 R2400 1SNA 113 003 R1000 1SNA 123 003 R1200 V0 1SNA 193 003 R1100 1SNA 118 707 R0300 1SNA 128 707 R0500 V0 1SNA 198 707 R0400 1SNA 114 202 R2500 (3) 1SNA 114 825 R0500 (3) 1SNA 103 619 R0400 (3) 1SNA 103 620 R0100 (3) 1SNA 116 795 R1100 (3)V0 1SNA 196 795 R1200 1SNA 187 312 R1400 1SNA 176 816 R1200 The terminal blocks M 4/6.C are equipped with a test socket DIA. 2,5 mm/.10" for connectors described in the section "Connectors". 1SNA 007 865 R2600	
1SNA 176 663 R0000 (1) 1SNA 176 664 R0100 (1) 1SNA 176 665 R0200 (1) 1SNA 176 666 R0300 (1) 1SNA 176 667 R0400 (1) 1SNA 174 784 R2000 1SNA 206 394 R0200	(5) 1SNA 176 663 R0000 (5) 1SNA 176 664 R0100 (5) 1SNA 176 665 R0200 (5) 1SNA 176 666 R0300 (5) 1SNA 176 667 R0400 (5) 1SNA 174 784 R2000 1SNA 206 394 R0200					
1SNA 173 627 R2100	1SNA 173 627 R2100	1SNA 173 627 R2100	1SNA 173 627 R2100	1SNA 173 627 R2100	1SNA 173 627 R2100	
(1) 1SNA 174 413 R1400 (1) 1SNA 116 541 R1200 (1)(2) 1SNA 179 623 R0300 (1)(2) 1SNA 179 625 R0500 (1)(2) 1SNA 174 781 R2500 1SNA 113 546 R1400 1SNA 113 548 R2600 1SNA 113 550 R2400 1SNA 178 745 R1400 1SNA 178 746 R1500 1SNA 163 427 R1700 1SNA 163 433 R1500 1SNA 107 038 R2500 1SNA 114 205 R2000	(5) 1SNA 174 413 R1400 (5) 1SNA 116 541 R1200 (2)(5) 1SNA 179 623 R0300 (2)(5) 1SNA 179 625 R0500 (2)(5) 1SNA 174 781 R2500 1SNA 113 546 R1400 1SNA 113 548 R2600 1SNA 113 550 R2400 1SNA 178 745 R1400 1SNA 178 746 R1500 1SNA 163 427 R1700 1SNA 163 433 R1500 1SNA 107 038 R2500 1SNA 114 205 R2000	1SNA 113 546 R1400 1SNA 113 548 R2600 1SNA 113 550 R2400 1SNA 178 745 R1400 1SNA 178 746 R1500	1SNA 113 546 R1400 1SNA 113 548 R2600 1SNA 113 550 R2400 1SNA 178 745 R1400 1SNA 178 746 R1500	1SNA 113 546 R1400 1SNA 113 548 R2600 1SNA 113 550 R2400 1SNA 178 745 R1400 1SNA 178 746 R1500	1SNA 113 546 R1400 1SNA 113 548 R2600 1SNA 113 550 R2400 1SNA 178 745 R1400 1SNA 178 746 R1500	
RC65 - RC610 RCT610	RC65 - RC610 RCT610 (5)	RC65 - RC610	RC65 - RC610	RC65 - RC610	RC65 - RC610	
Note : (1) A circuit separator SC may be required with the use of these accessories. (2) See "Notes". (3) End sections and separators snapped on rails. (5) Use of these accessories requires the user to cut out the partition.						

Single pole, multiclamp
terminal blocks

Screw clamp

DIN 1 - 3

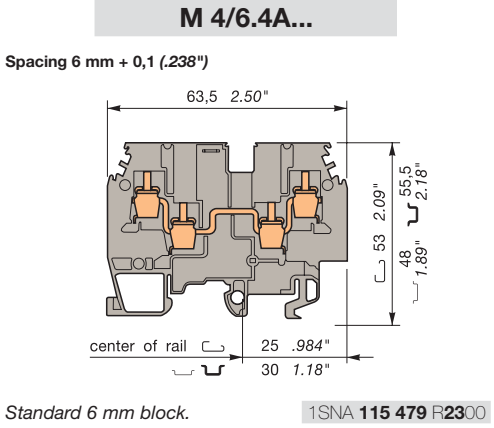
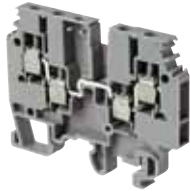

Colour	Type	Part numbers
Standard blocks		
Grey	<input type="checkbox"/> M 4/6.4A	1SNA 115 479 R2300
Blue	<input type="checkbox"/> M 4/6.4A.N	1SNA 125 479 R2500
Beige V0	<input type="checkbox"/> M 4/6.4A.V0	1SNA 195 479 R2400
M 4/6.4A with partition		
Grey	<input type="checkbox"/> M 4/6.4A.1	1SNA 115 482 R0700

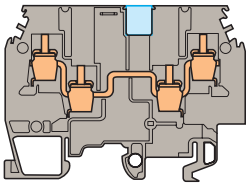

--	--

Accessories		Type	Part numbers
	1 End section	grey	FEM4A th. 3,0 mm 1SNA 116 629 R2200
		blue	FEM4A th. 3,0 mm 1SNA 126 629 R2400
		yellow	FEM4A th. 3,0 mm 1SNA 103 863 R2100
		beige	FEM4A V0 V0 th. 3,0 mm 1SNA 196 629 R2300
	2 Circuit separator	grey	SCM6 1SNA 113 003 R1000
		blue	SCM6 1SNA 123 003 R1200
		yellow	SCM6 1SNA 103 020 R2300
		beige	SCM6 V0 V0 1SNA 193 003 R1100
	3 Test socket	AL2 (1) DIA. 2,0 mm	1SNA 163 043 R2100
		AL3 (1) DIA. 3,0 mm	1SNA 163 261 R0000
	4 Test device	DCJ yellow	1SNA 173 059 R0300
	5 Test plug	FC2 DIA. 2,0 mm	1SNA 007 865 R2600

	7 Assembled jumper bar	32 A	BJMI6 (1)(2) 2 poles	1SNA 176 663 R0000
		32 A	BJMI6 (1)(2) 3 poles	1SNA 176 664 R0100
		32 A (with IP 20 protection)	BJMI6 (1)(2) 4 poles	1SNA 176 665 R0200
		32 A	BJMI6 (1)(2) 5 poles	1SNA 176 666 R0300
		32 A	BJMI6 (1)(2) 10 poles	1SNA 176 667 R0400
	8 Jumper bar not assembled	32 A	BJS6 (1)(2) 20 poles	1SNA 174 784 R2000
	Post + screw + washer IP20		EV6I	1SNA 206 394 R0200
	9 Connector plate	EL6		1SNA 173 627 R2100

	12 Alternated jumper bar	35 A	BJA6 (1)(2)	1SNA 116 541 R1200
	13 Universal jumper bar	50 A	BJDP1 (1)(2) spacing 6 <-> spacing 16	1SNA 179 623 R0300
		70 A	BJDP3 (1)(2) spacing 6 <-> spacing 12	1SNA 179 625 R0500
		50 A	BJDP4 (1)(2) spacing 6 <-> spacing 8 or 10	1SNA 174 781 R2500
			BJP6 (1)(2)	1SNA 174 413 R1400
	14 Pivoting jumper bar	35 A	PC6 2 poles	1SNA 113 546 R1400
		35 A	PC6 3 poles	1SNA 116 536 R0500
		35 A	PC6 4 poles	1SNA 116 537 R0600
		35 A	PC6 10 poles	1SNA 113 548 R2600
			EIP	1SNA 113 550 R2400
	15 Comb-type jumper bar	35 A	AD2,5	1SNA 114 205 R2000

	16 IDC jumper			

	Insulating tip			

	R See section on marking method	RC65 - RC610	RCT610	

Nota : (1) A circuit separator SC may be required with the use of these accessories.
(2) Use of these accessories requires the user to cut out the partition of the terminal block M 4/6.4A.1.

refer to the section "Special Applications" for part numbers and characteristics.

End stop		th. 9 mm	BADL	V0	1SNA 399 903 R0200
End stop		th. 10 mm	BAM2	V2	1SNA 206 351 R1600
End stop		th. 10 mm	BAM2 V0	V0	1SNA 296 351 R0000
Rail		35 x 7,5 x 1	PR3.Z2		1SNA 174 300 R1700
Rail		35 x 15 x 2,3	PR4		1SNA 168 500 R1200
Rail		35 x 15 x 1,5	PR5		1SNA 168 700 R2200
Rail		32 x 15 x 1,5	PR1.Z2		1SNA 163 050 R0400

Other end stops, rails and accessories : see section on accessories.

Characteristics

Wire size		IEC NFC DIN	UL	CSA
Screw clamp	Rigid	0,2-4 mm²	22-10 AWG	12 AWG maxi.
	Flexible	0,22-4 mm²	22-10 AWG	12 AWG maxi.

Voltage		800 V	600 V	600 V
Rated				
Impulse withstand		8 kV		
Pollution degree		3		

Current		32 A	20 A	25 A
Rated				

Wire size		4 mm² / A4	10 AWG	12 AWG
Rated / Gauge				
Wire strip. length	Recomm. Screwdriver	Recomm. torque	Protection	
9,5 mm	4 mm	0,5-0,8 Nm	IP 20	
.37"	.157"	4,4-7,1 lb.in	NEMA 1	

Notes

The use of some accessories may decrease the block's voltage rating. For more information, consult us.