

# AC FANS

## Model 148

Size: 172 mm x 38 mm (6.75" x 1.5")

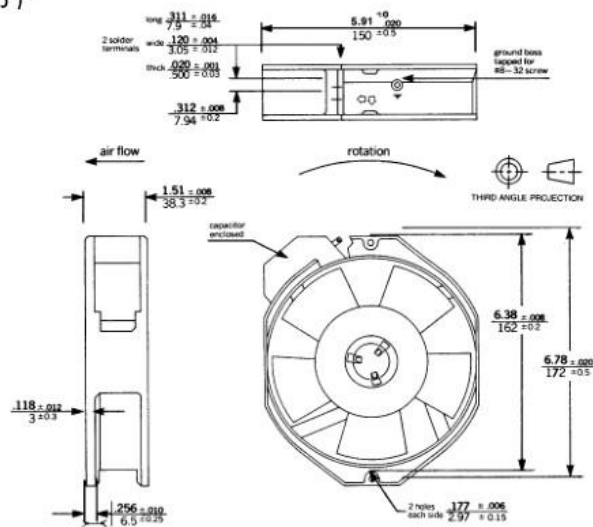

Part Number	Bearings	Voltage(VAC)	Frequency(Hz)	Current(mA)	Input(watts)	Noise(dBA)	Speed(rpm)	Airflow(cfm)
148VK-0282-030	Ball	115	50/60	300/270	32/32	54/57	2850/3300	213/253
148VK-0281-030	Ball	220	50/60	200/170	35/33	53/57	2800/3200	213/249
148VP-0282-030	Ball	115	50/60	120/160	14/18	50/45.5	2350/2100	172/149
148VP-0281-030	Ball	220	50/60	70/100	16/22	49/44	2400/2000	174/149
148VE-0282-030	Ball	115	50/60	100/90	11/11	36/39	1400/1650	104/123
148VE-0281-030	Ball	220	50/60	60/60	13/14	36/39	1400/1650	104/123

148VE Performance Curve

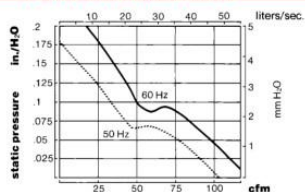

148VP Performance Curve

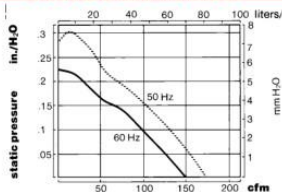

148VK Performance Curve

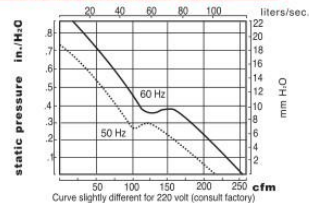

**ETRI Model 148 AC FANS**  
**Size: 172 mm x 38 mm (6.75" x 1.5")**



**ELECTRICAL SPECIFICATIONS**

Item	Specification	Conditions/Tolerances
Motor type	permanent split capacitor	multi-pole
Rated Voltage	115 VAC or 220 VAC	±10%
Frequency	50/60 Hz.	Able to operate at either frequency
Input Current	At nominal voltage	±10%
Input Power	At nominal voltage	±10%
Max air flow / Back pressure	All tested in submerged orifice chamber	±4% cfm/±8% pressure
Dielectric strength	2250 VAC	5 sec, 4mA leakage
Electrical Connection	"110" Faston terminals	
Speed	At nominal voltage	±4%

**MECHANICAL SPECIFICATIONS**

Item	Specification	Conditions
Life expectancy	50,000 hours	continuous operation @ 25° C, 65% relative humidity
Bearing	ball bearing	Use under 70° C
Airflow direction	air intake over impeller	
Housing material	Zamak (zinc alloy)	single piece die-cast housing
Impeller	Lexan 500-10% glass filled	UL 94V-0
Weight	1.1 kg (38.7 oz)	
Rotation	clock-wise viewed from impeller	

**ENVIRONMENTAL SPECIFICATIONS**

Item	Specification	Conditions
Operating temperature	-10 to +70° C	Ball bearing
Storage temperature	-40 to +70° C	6 months max.
Paint	Black enamel	
Acoustical	Anechoic chamber at free air	Microphone - 1 meter away

**PROTECTION**

Item	Specification	Conditions
Locked rotor	thermal/impedance protected	148VK thermal protection/148VE,148VP impedance protected
Insulation class	UL class A	
Agency approvals	UL, CSA, VDE*, CE	
Warranty	3 years	

\*VDE approval available on some models. Consult factory.

**PANEL CUT-OUT**

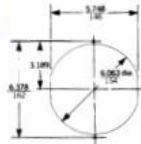

**ACCESSORIES**

ETRI fans are available with a wide range of accessories, from finger guards to filter assemblies to special termination. Request our accessories brochure or call your nearest distributor for complete details.