

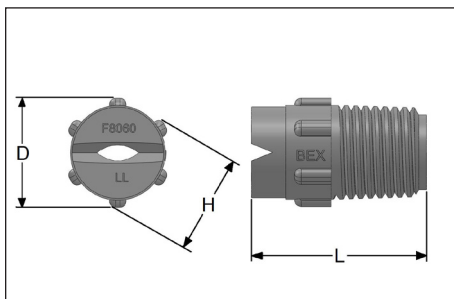

# F40 MOLDED SPRAY NOZZLE

FLAT SPRAY • THREADED CONNECTION



Spray angle not exactly as shown

## SPRAY CHARACTERISTICS:

F-series spray nozzles produce a flat, fan shaped spray pattern, with spray angles available from 0° to 110° at 40 PSI.

## CONSTRUCTION:

Each BEX molded nozzle is designed with a series of "knobs" which makes them easier to finger tighten than a hex, especially when wet. The design feature of a small starter barrel greatly reduces the tendency to strip or cross-thread the nozzle during installation.

## MATERIALS AVAILABLE:

### POLYOROPYLENE (LL) - (Green)

Excellent chemical and corrosion resistance. Useful up to 175°F

**NATURAL POLYPROPYLENE (LN)** Non-pigmented for optimum purity

**PVDF (KK) - (Red)** Excellent durability and abrasion resistance and is inert to most chemicals. Useful up to 300°F.

### NATURAL PVDF (KN)

Non-pigmented for optimum purity.

## TYPICAL APPLICATIONS:

- Printed Circuit Board Washing
- PCB-Etching/Developing
- Semiconductor Manufacturing
- Pressure Washing
- Street Sweeping
- Carpet Cleaning
- Fruit and Vegetable Washing
- Plating Processing
- Dust Suppression
- Acid Spraying
- Degreasing
- Coating Applications
- Foam Control
- Metal Washing
- Chemical Spraying
- Rising Parts

NOZZLE TYPE	Dim. D	Dim. H	Dim. L
1/8F	0.62	9/16	0.8
1/4F	0.62	9/16	1.0
3/8F	0.77	11/16	1.0

Model ID	Equiv. Orif. Dia.	Capacities at Various Pressures													Spray Angles		
		0.3 bar	0.5 bar	0.7 bar	1.0 bar	1.5 bar	2 bar	3 bar	4 bar	5 bar	7 bar	10 bar	20 bar	30 bar	15 bar	3 bar	5 bar
1/8F4002	0.86	0.250	0.32	0.38	0.46	0.56	0.64	0.79	0.91	1.02	1.21	1.44	2.04	2.50	26	40	53
1/4F4002	0.86	0.250	0.32	0.38	0.46	0.56	0.64	0.79	0.91	1.02	1.21	1.44	2.04	2.50	26	40	53
1/8F40025	0.97	0.312	0.40	0.48	0.57	0.70	0.81	0.99	1.14	1.27	1.51	1.80	2.55	3.12	26	40	56
1/8F4003	1.07	0.37	0.48	0.57	0.68	0.84	0.97	1.18	1.37	1.53	1.81	2.16	3.06	3.7	39	40	56
1/4F4003	1.07	0.37	0.48	0.57	0.68	0.84	0.97	1.18	1.37	1.53	1.81	2.16	3.06	3.7	39	40	56
1/8F4004	1.22	0.50	0.64	0.76	0.91	1.12	1.29	1.58	1.82	2.04	2.41	2.88	4.1	5.0	40	40	59
1/4F4004	1.22	0.50	0.64	0.76	0.91	1.12	1.29	1.58	1.82	2.04	2.41	2.88	4.1	5.0	40	40	59

\* TABLE CONTINUES ON FOLLOWING PAGE



F-MOLDED NOZZLE SPECIFICATIONS

40 DEGREE SPRAY ANGLE • FLAT SPRAY • THREADED CONNECTION

Model ID	Equiv. Orif. Dia.	Capacities at Various Pressures													Spray Angles		
		0.3 bar	0.5 bar	0.7 bar	1.0 bar	1.5 bar	2 bar	3 bar	4 bar	5 bar	7 bar	10 bar	20 bar	30 bar	1.5 bar	3 bar	5 bar
1/8F4005	1.37	0.62	0.81	0.95	1.14	1.40	1.61	1.97	2.28	2.55	3.01	3.6	5.1	6.2	26	40	46
1/4F4005	1.37	0.62	0.81	0.95	1.14	1.40	1.61	1.97	2.28	2.55	3.01	3.6	5.1	6.2	26	40	46
1/8F4006	1.50	0.75	0.97	1.14	1.37	1.67	1.93	2.37	2.73	3.06	3.6	4.3	6.1	7.5	37	40	44
1/4F4006	1.50	0.75	0.97	1.14	1.37	1.67	1.93	2.37	2.73	3.06	3.6	4.3	6.1	7.5	37	40	44
1/4F4008	1.73	1.00	1.29	1.53	1.82	2.23	2.58	3.16	3.6	4.1	4.8	5.8	8.2	10.0	35	40	43
1/4F4010	1.93	1.25	1.61	1.91	2.28	2.79	3.2	3.9	4.6	5.1	6.0	7.2	10.2	12.5	30	40	43
3/8F4010	1.93	1.25	1.61	1.91	2.28	2.79	3.2	3.9	4.6	5.1	6.0	7.2	10.2	12.5	30	40	43
1/4F4015	2.39	1.87	2.42	2.86	3.4	4.2	4.8	5.9	6.8	7.6	9.0	10.8	15.3	18.7	35	40	41
3/8F4015	2.39	1.87	2.42	2.86	3.4	4.2	4.8	5.9	6.8	7.6	9.0	10.8	15.3	18.7	34	40	41
1/4F4020	2.74	2.50	3.2	3.8	4.6	5.6	6.4	7.9	9.1	10.2	12.1	14.4	20.4	25.0	33	40	43
3/8F4020	2.74	2.50	3.2	3.8	4.6	5.6	6.4	7.9	9.1	10.2	12.1	14.4	20.4	25.0	33	40	43
1/4F4030	3.38	3.7	4.8	5.7	6.8	8.4	9.7	11.8	13.7	15.3	18.1	21.6	30.6	37	34	40	45
3/8F4030	3.38	3.7	4.8	5.7	6.8	8.4	9.7	11.8	13.7	15.3	18.1	21.6	30.6	37	34	40	45
1/4F4040	3.89	5.0	6.4	7.6	9.1	11.2	12.9	15.8	18.2	20.4	24.1	28.8	41	50	33	40	43
3/8F4040	3.89	5.0	6.4	7.6	9.1	11.2	12.9	15.8	18.2	20.4	24.1	28.8	41	50	33	40	43
1/4F4050	4.34	6.2	8.1	9.5	11.4	14.0	16.1	19.7	22.8	25.5	30.1	36	51	62	35	40	46
3/8F4050	4.34	6.2	8.1	9.5	11.4	14.0	16.1	19.7	22.8	25.5	30.1	36	51	62	35	40	46
1/4F4060	4.75	7.5	9.7	11.4	13.7	16.7	19.3	23.7	27.3	30.6	36	43	61	75	37	40	48
3/8F4060	4.75	7.5	9.7	11.4	13.7	16.7	19.3	23.7	27.3	30.6	36	43	61	75	37	40	48
1/4F4070	5.13	8.7	11.3	13.3	16.0	19.5	22.6	27.6	32	36	42	50	71	87	35	40	46
3/8F4070	5.13	8.7	11.3	13.3	16.0	19.5	22.6	27.6	32	36	42	50	71	87	35	40	46