

2007 SERIES

Vertical Hold Down Clamps | Product Overview

Features:

- Large hand clearance for improved safety
- Bolt pattern interchangeable with 207 Series
- Over two times the holding capacity of 207 Series
- Hardened bushings at key pivot points
- Near vertical clamping contact
- 5 handle colors - see page MC-PRO-7 for details

Applications:

- Checking fixtures
- Assembly & test
- Light machining
- Woodworking

Also Available:

See page MC-ACC-1 for accessories
Accepts M8 or 5/16 spindle accessories

Covered under one or more U.S./International Patents

2007-**U/USS** Flanged Base U-Bar



-**USS** Stainless
Steel Model



2007-**U-LS-BLK** ① Blackout Series Flanged Base U-Bar



2007-**S** Flanged Base Solid Bar



2007-**UB** Straight Base U-Bar



2007-**UB-LS-BLK** ① Blackout Series Straight Base U-Bar



2007-**SB** Straight Base Solid Bar



2007-**UR/URSS** Flanged Base U-Bar DESTACO® Toggle Lock Plus



-**URSS** Stainless
Steel Model



2007-**SR** ① Flanged Base Solid Bar DESTACO® Toggle Lock Plus



2007-**UBR** Straight Base U-Bar DESTACO® Toggle Lock Plus



2007-**SBR** ① Straight Base Solid Bar DESTACO® Toggle Lock Plus



2007-**UF** Front Mount Base U-Bar



Color Handles

Available on models in this series that use standard red handles.* Add **-Y**, **-G**, **-B**, **-K** to end of model number.

*Excludes Blackout Series, Toggle Lock Plus levers or dipped handles.



Model	Max. Holding Capacity	Clamp Bar Opening (+10°)	Handle Opening (+10°)	Weight	Accessories (Supplied)		
					Bolt Retainer	Spindle Assembly	Flanged Washers
2007-U	[1000 lbf] 4450 N	76°	64°	[1.20 lbs] 0,54 kg	--	2007208-M	507107
2007-USS					--	207943-M	507907
2007-U-LS-BLK ⓘ					--	--	507107-BLK
2007-S					2007115-E	--	--
2007-UB					--	2007208-M	507107
2007-UB-LS-BLK ⓘ					--	--	507107-BLK
2007-SB					2007115-E	--	--
2007-UR					--	2007208-M	507107
2007-URSS					--	207943-M	507907
2007-SR ⓘ					2007115-E	--	--
2007-UBR					--	2007208-M	507107
2007-SBR ⓘ					2007115-E	--	--
2007-UF				[1.57 lbs] 0,71 kg	--	2007208-M	507107

ⓘ This item is available upon request

Holding Capacities

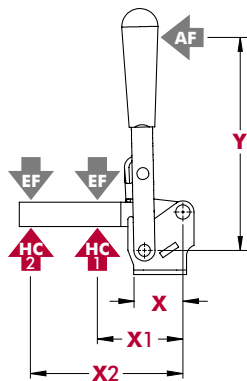

Model	X	X1	X2	Y	±HC1	±HC2	±EF(X1):AF	±EF(X2):AF
2007-()	[1.59] 40,5	[1.95] 49,5	[3.92] 99,5	[5.16] 131	[1000 lbf] 4450 N	[470 lbf] 2090 N	10:1	5.3:1

Dimensions shown "mm [inch]" ± HC = Holding Capacity, EF = Exerting Force, AF = Applied Force
See page MC-TEC-4 for additional information.

2007 SERIES

Vertical Hold Down Clamps | Dimensions | -U/-USS/-S/-UB/-SB/-UR/-URSS/-SR/-UBR/-SBR

2007-U
Flanged Base
U-Bar

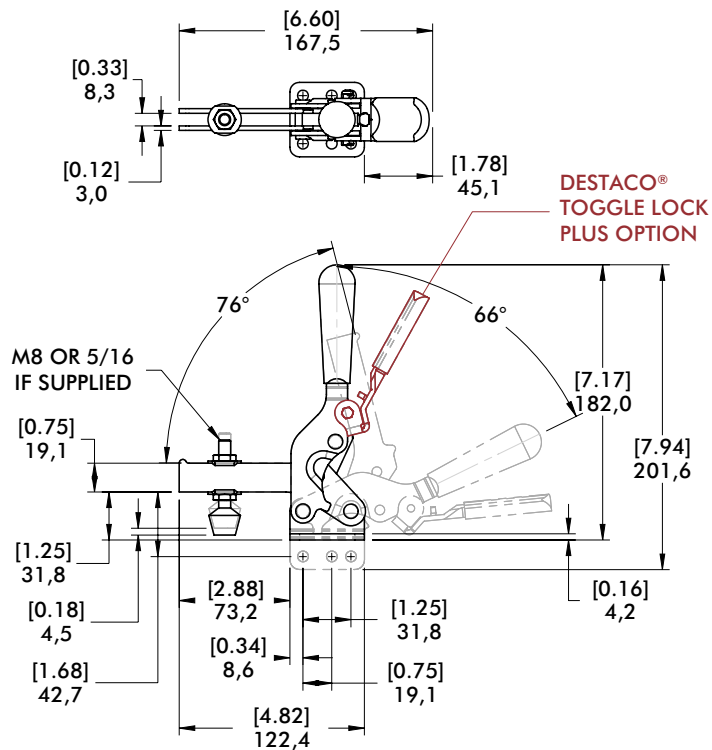
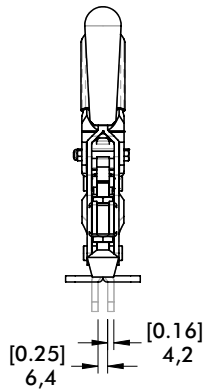

2007-SB
Straight Base
Solid Bar

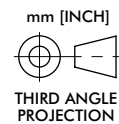
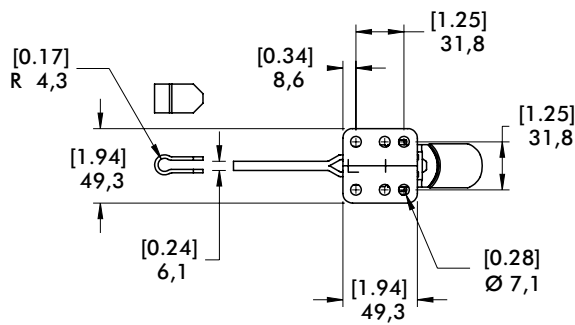

2007-UF
 Flanged Base
 U-Bar
 DESTACO®
 Toggle Lock
 Plus

