

## Specifications

For other materials or modifications, please consult TESCOm.

### OPERATING PARAMETERS

Pressure rating per criteria of ANSI/ASME B31.3

#### Maximum Inlet Pressure

500, 3000 psig / 34.5, 207 bar

#### Outlet Pressure Ranges

0-25, 0-50, 0-100, 0-150, 0-200 psig  
0-1.7, 0-3.4, 0-6.9, 0-10.3, 0-13.8 bar

#### Design Proof Pressure

150% of rated pressure

#### Leakage

**Internal:** Bubble-tight

**External:**  $< 2 \times 10^{-8}$  atm cc/sec He

#### Operating Temperature

-40°F to 140°F / -40°C to 60°C

#### Flow Capacity

$C_v = 1.0$

$C_v = 1.8$  (Optional)

### MEDIA CONTACT MATERIALS

#### Body

Brass, 316 Stainless Steel

#### Bonnet

300 Series Stainless Steel

#### Diaphragm

316 Stainless Steel

#### Seat

**3000 psig / 207 bar Inlet:** PCTFE

**500 psig / 34.5 bar Inlet:** PTFE

#### Seat Retainer

Nitronic 60

#### Seal

PTFE

#### Remaining Parts

316 Stainless Steel

### OTHER

#### Cleaning

CGA 4.1 and ASTM G93

#### Weight (without gauges)

3.5 lbs / 1.6 kg

Teflon® is a registered trademark of E.I du Pont de Nemours and Company.



TESCOM 44-3200 Series is a compact, high flow, high purity single-stage regulator for specialty, flammable and industrial gas flows of 5-50 SCFM / 141-1415 SLPM. Diffusion-resistant metal diaphragm seal ensures gas purity and integrity.

### Applications

- Laboratory and point-of-use gas systems
- Laser assist and resonator gases
- Glove box and isolators

### Features and Benefits

- Available in 316 Stainless Steel or Brass
- Choice of inlet pressure ratings: 500 or 3000 psig / 34.5 or 207 bar maximum
- True metal-to-metal diaphragm seal to minimize diffusion
- Five outlet pressure ranges are available
- Gauge ports are standard
- Optional high flow model ( $C_v = 1.8$ ) is available
- Panel mounting is optional
- Non-venting is standard
- Flanged end connections available

# 44-3200 SERIES

## 44-3200 Series Regulator Drawing

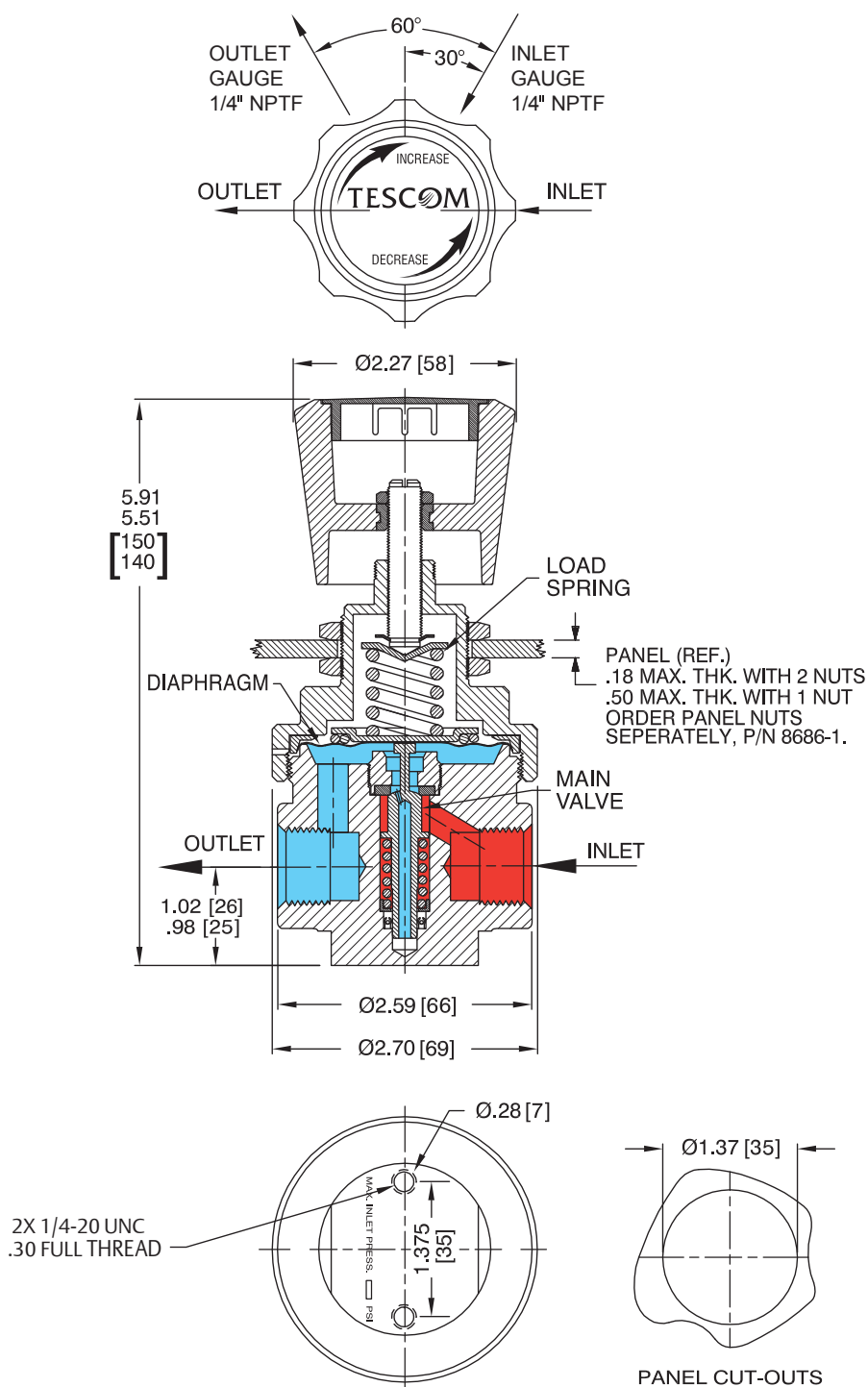

All dimensions are reference and nominal  
Metric [millimeter] equivalents are in brackets

44-3200 Series Regulator with Flanges Drawing

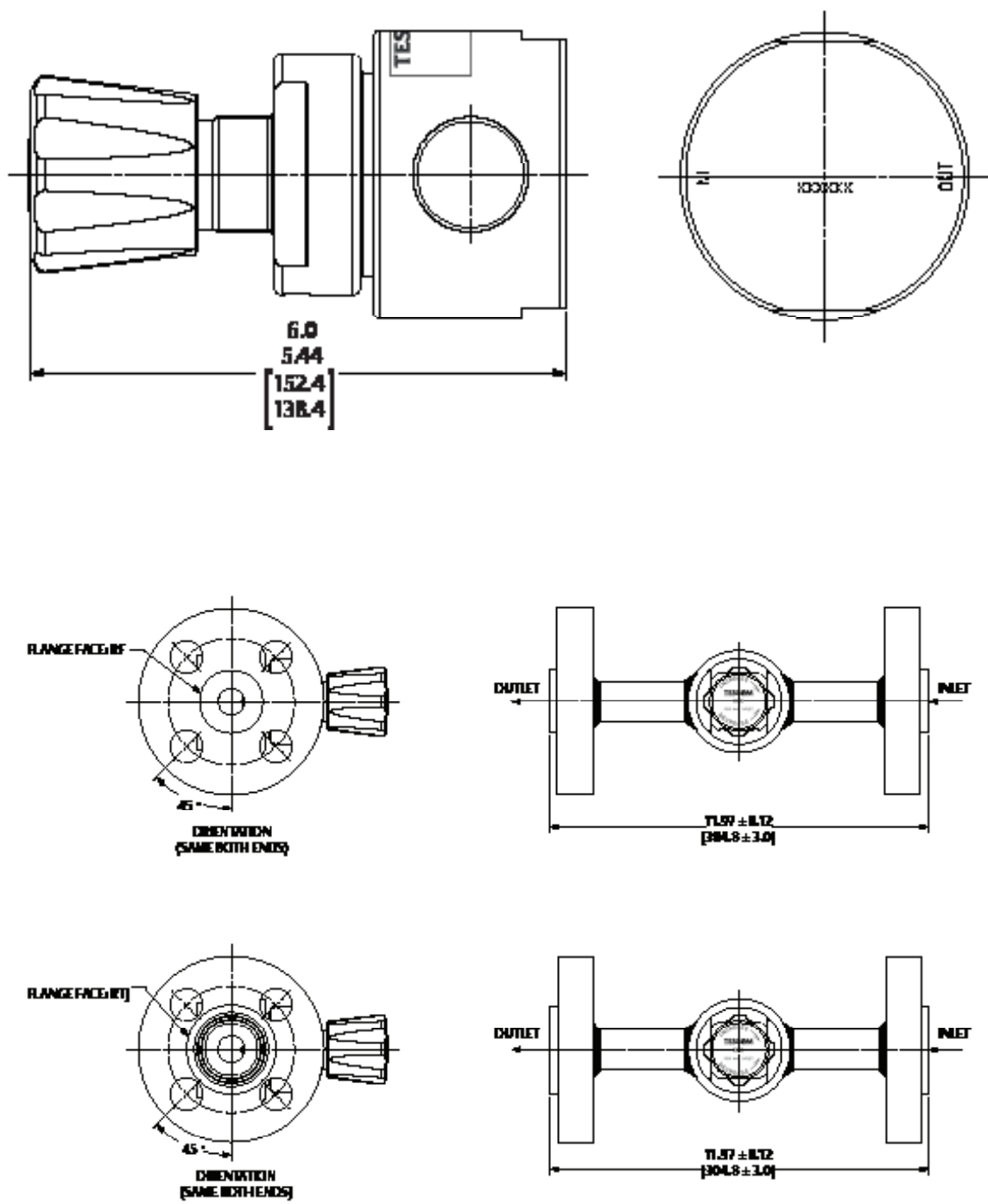

All dimensions are reference and nominal  
Metric [millimeter] equivalents are in brackets

## 44-3200 SERIES

### 44-3200 Series Regulator Flow Charts

For more information on how to read flow curves, please refer to the Flow Curves and Calculations document (debul2007x012) in the TESCO catalog or on [www.tescom.com](http://www.tescom.com).

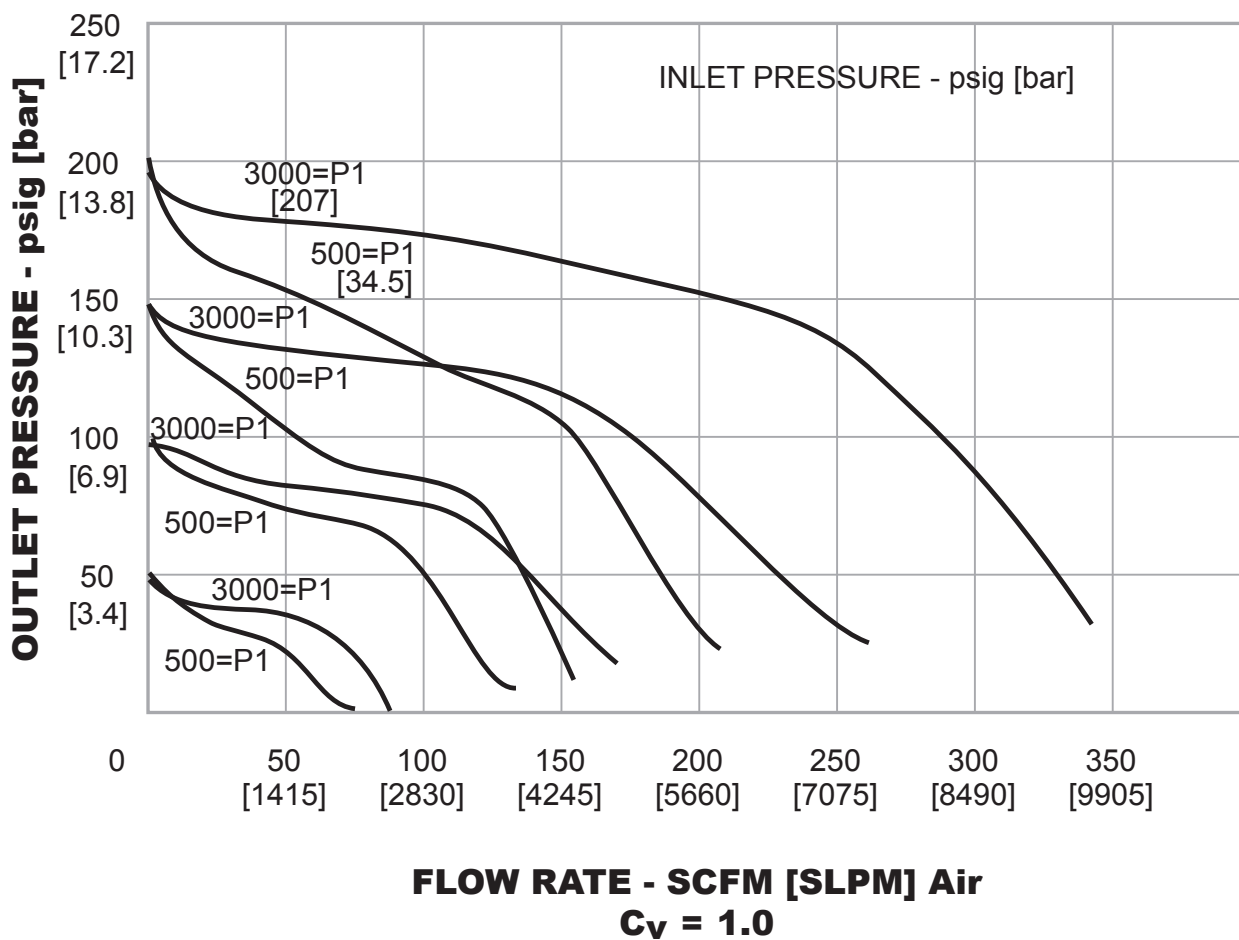

44-3200 Series Regulator Flow Charts

For more information on how to read flow curves, please refer to the Flow Curves and Calculations document (debul2007x012) in the TESCO catalog or on [www.tescom.com](http://www.tescom.com).

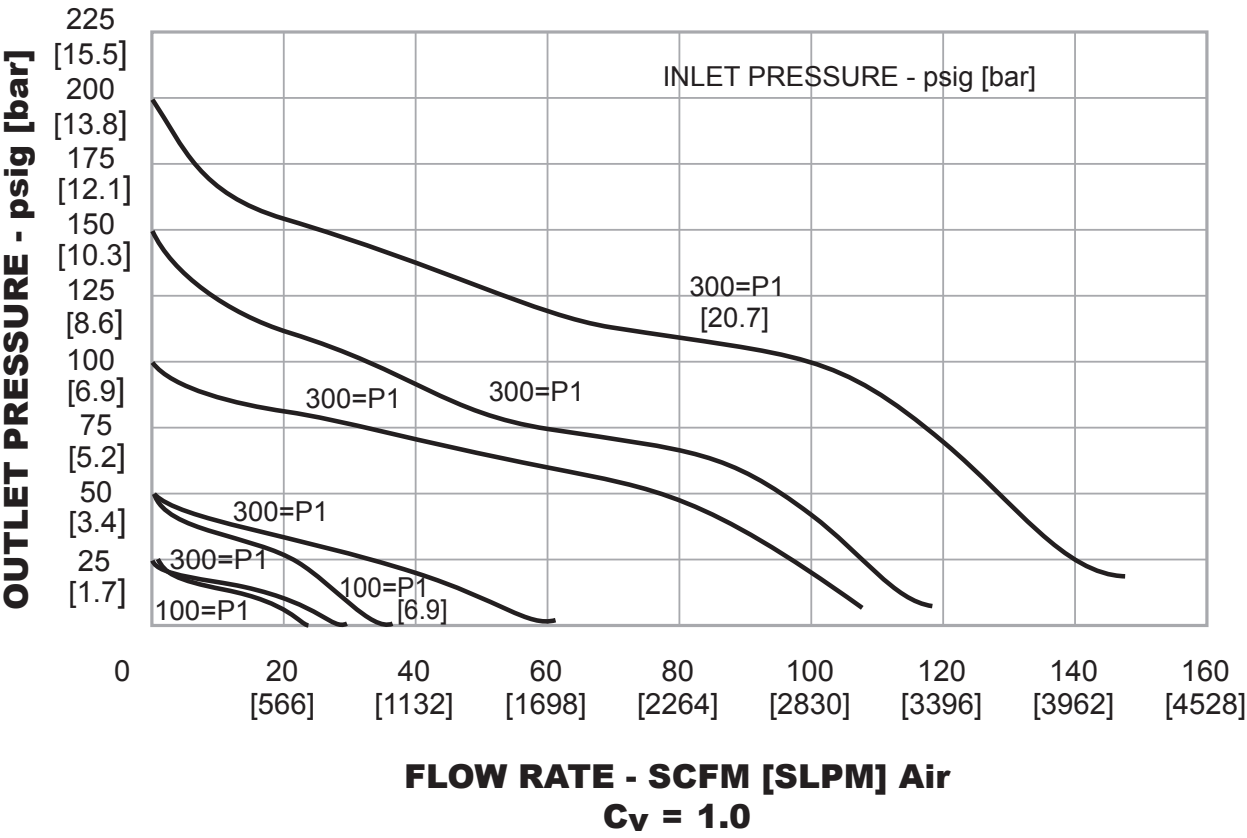

## 44-3200 SERIES

### 44-3200 Series Regulator Part Number Selector



#### Learn more about common options.

For modifications, repair kits and accessories, contact factory.

#### Threaded End Connection Part Number Selection

44-32	6	1	J		2	8	1	
BASIC SERIES	BODY MATERIAL	OUTLET PRESSURE RANGES	SOFT GOODS		INLET AND OUTLET PORT TYPE	INLET AND OUTLET PORT SIZE	MAXIMUM INLET PRESSURE	OPTIONS
			SEAT	SEAL				
44-32	1 – Brass  6 – 316 Stainless Steel	0 – 0-25 psig 0-1.7 bar  1 – 0-50 psig 0-3.4 bar  2 – 0-100 psig 0-6.9 bar  3 – 0-150 psig 0-10.3 bar  4 – 0-200 psig 0-13.8 bar	H – PTFE  J – PCTFE	PTFE, O-ring  PTFE, Spring Energized Lip Seal	2 – NPTF	6 – 3/8"  8 – 1/2"	1 – 3000 psig 207 bar  3 – 500 psig 34.5 bar	-001 – One 1/4" gauge port at 90°, C <sub>V</sub> = 1.0  -003 – No gauge ports  -296 – One 1/4" gauge port at 90°, C <sub>V</sub> = 1.8

#### Flanged End Connector Part Number Selection:

44-32W	6	2	1					B	1	52	1	
BASIC SERIES	BODY, PIPE & FLANGE MATERIAL	OUTLET PRESSURE RANGES	DASH NO	FLOW CAPACITY	SEAT	SEAL	OPERATING TEMPERATURE	GAUGE PORT OPTIONS	FLANGE SIZE	FLANGE CLASS	FLANGE FACE	
44-32W	6 – 316 SST	0 – 0-25 psig 0-1.7 bar	1	1.0	PCTFE	PTFE	-20 to 140°F -29 to 60°C	A – R.H. Inlet, no gauge port		1 – 1/2" 3 – 1"	11 – 150# 21 – 300# 41 – 600# 52 – 900# / 1500# 63 – 2500#	1 – RF 2 – RTJ
		1 – 0-50 psig 0-3.4 bar 2 – 0-100 psig 0-6.9 bar 3 – 0-150 psig 0-10.3 bar 4 – 0-200 psig 0-13.8 bar	2	1.0	PTFE	PTFE	-20 to 165°F -29 to 74°C	B – R.H. Inlet, in & out gauge port at 60°  J – R.H. Inlet, 2 outlet gauge port at 90°	