

Fine setting valve

- Qn = 900 l/min
- Actuating element handwheel
- Internal thread
- Poppet valve



Version	Poppet valve
Working pressure min./max.	See table
Adjustment range min./max.	See table
Ambient temperature min./max.	-25 ... 70 °C
Medium temperature min./max.	-25 ... 70 °C
Medium	Compressed air
Nominal flow Qn	900 l/min
Hysteresis	0.15 bar
Weight	0,6 kg

Technical data

Part No.	Compressed air connection	Compressed air connection type
	Input	Input
3610607000	G 1/4	Internal thread
3610607100	G 1/4	Internal thread
3610607200	G 1/4	Internal thread
3610607300	G 1/4	Internal thread
3610607400	G 1/4	Internal thread
3610607500	G 1/4	Internal thread
3610607600	G 1/4	Internal thread
3610607700	G 1/4	Internal thread

Part No.	Compressed air connection	Working pressure min./max.	Adjustment range min./max.
	Output		
3610607000	G 1/4	0,1 ... 10 bar	0,1 ... 1,1 bar
3610607100	G 1/4	0,1 ... 10 bar	0,1 ... 2,6 bar
3610607200	G 1/4	0,1 ... 10 bar	0,1 ... 3,6 bar
3610607300	G 1/4	0,1 ... 10 bar	0,1 ... 4,1 bar
3610607400	G 1/4	0,1 ... 10 bar	0,1 ... 4,6 bar
3610607500	G 1/4	0,1 ... 10 bar	0,1 ... 5,1 bar
3610607600	G 1/4	0,1 ... 10 bar	0,1 ... 7,1 bar
3610607700	G 1/4	0,1 ... 12 bar	0,1 ... 10,1 bar

Part No.	Parallel pressure displacement
3610607000	1,3 bar
3610607100	1,4 bar
3610607200	1,4 bar
3610607300	1,4 bar
3610607400	1,4 bar

Part No.	Parallel pressure displacement
3610607500	1,4 bar
3610607600	0,8 bar
3610607700	-

Technical information

Material	
Housing	Die cast zinc
Seals	Acrylonitrile butadiene rubber

Dimensions

Dimensions

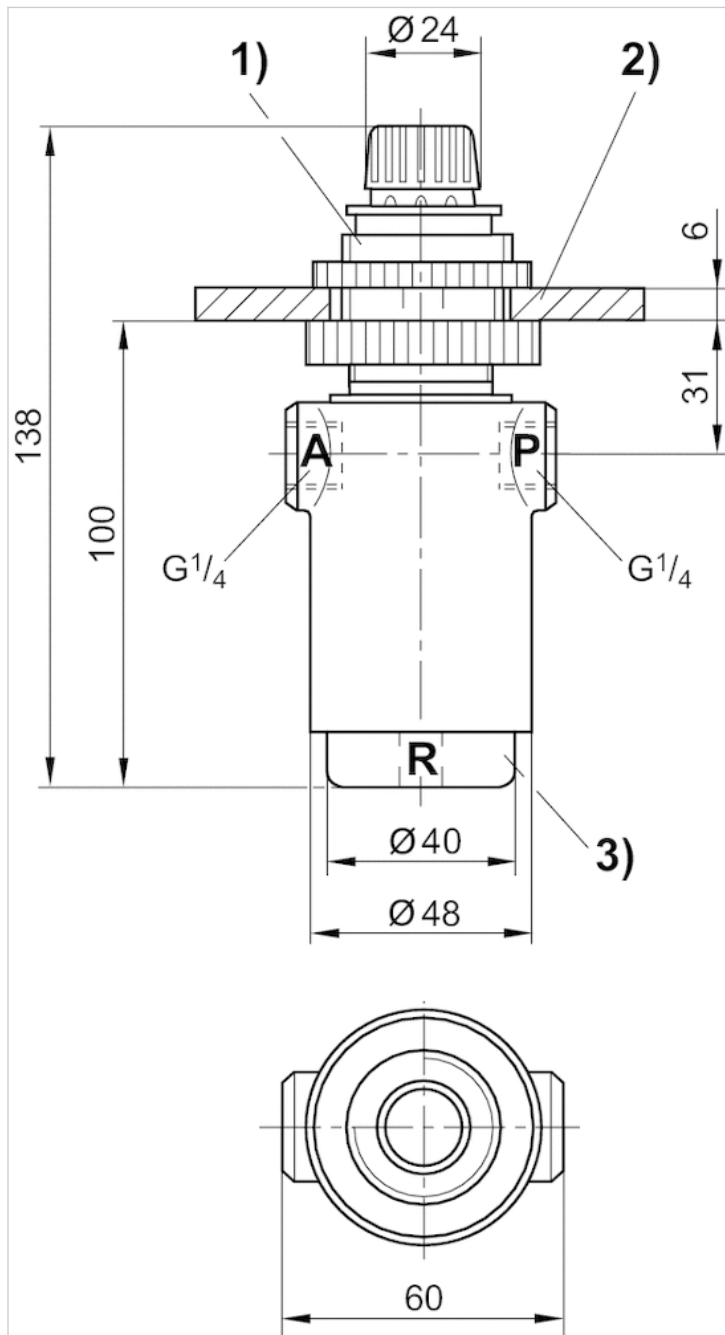

1) The handwheel can be adjusted once the locking ring has been pulled up. 2) hole for mounting plate Ø 31 mm 3) screw cap

A = connection output

P = connection input

R = Port exhaust

Diagrams

Pressure characteristics curve

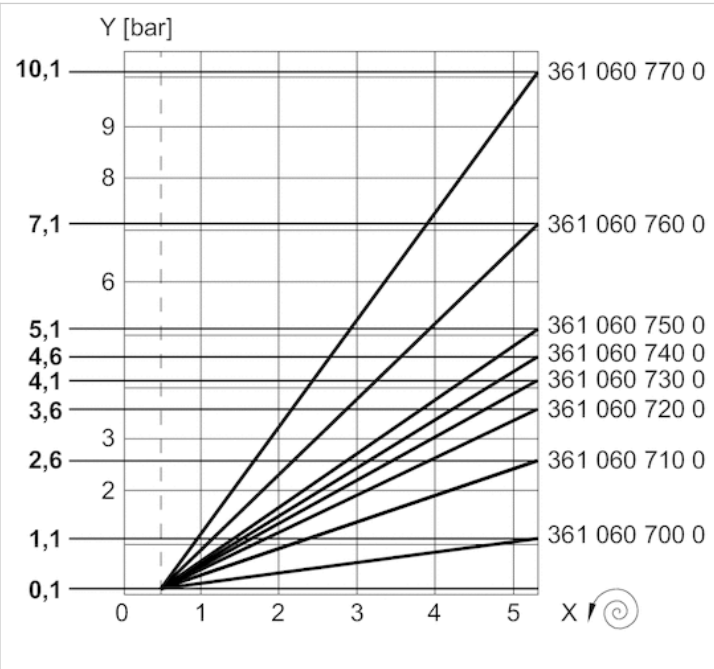

x = rotations of the handwheel
The characteristic curve can be moved parallel to the illustrated characteristic curve (in the y direction) using the screw cap.

Flow rate characteristic

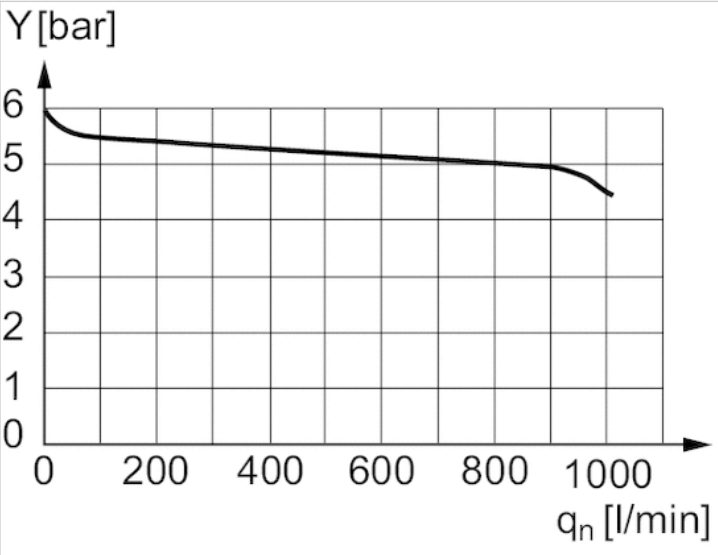

input pressure: 8 bar, supply pressure: 6 bary: pressure in line "A" [bar]