

EP PFA Manual Valves, 1 1/2" and 2", 2-way

Enable high flow, bulk chemical delivery in high-purity, corrosive chemical applications

Our EP PFA 1-1/2" and 2" manual valves are uniquely designed to ensure port-to-port seal integrity and are capable of distributing large volumes of high-purity chemical. Available in 2-way manual multi-turn configurations and industry-leading port connections including PrimeLock®, flare, or 40A or 50A PureBond® pipe, our portfolio of 1-1/2" and 2" EP PFA valves will meet your most demanding bulk chemical delivery needs in semiconductor and flat panel display applications.



1-1/2" and 2" EP PFA manual valves

APPLICATIONS

- Bulk chemical delivery in the semiconductor and flat panel display markets
- High-purity, corrosive chemical handling within the semiconductor and flat panel display markets

FEATURES & BENEFITS

High C_v flows	Capable of carrying large volumes of chemical with minimal pressure drop
Visual valve position indication	Allow easy on/off control
PFA and PTFE wetted materials of construction	Provide chemical resistance to a broad range of corrosive chemicals

SPECIFICATIONS

Materials	All wetted parts parts	PFA, PTFE
	Nonwetted parts	Copper, Viton®, stainless steel 304, brass, PP+G/F, PC
Pressure range	689.5 kPa (100 psig) @ 21°C (70°F) fluid temperature	
	441 kPa (64 psig) @ 90°C (194°F) fluid temperature	
Temperature range	21° to 90°C (70° to 194°F)	

DIMENSIONS

1½" EP PFA, Manual Valve

Front View

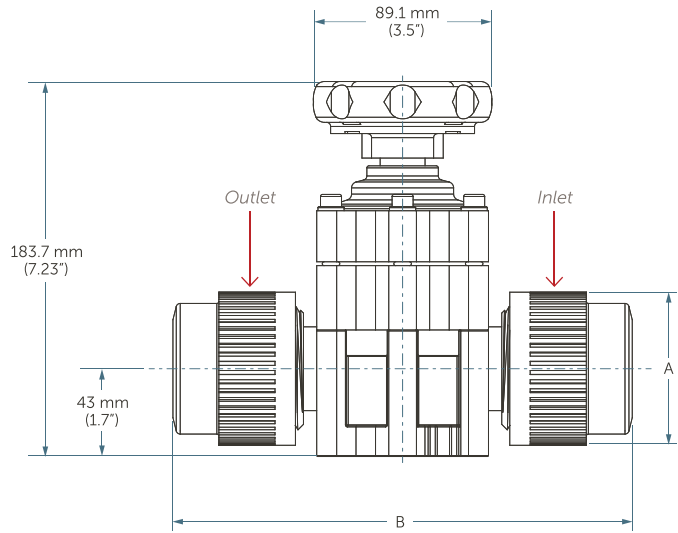

Port connection	Flow factor	Dimensions	
		A	B
1-1/2" EP PFA flare	16.6 C _v (14.4 K _v)	75.0 mm (2.95")	225.0 mm (8.86")
1-1/2" PrimeLock	16.6 C _v (14.4 K _v)	78.0 mm (3.07")	232.0 mm (9.13")
40 mm PrimeLock	16.6 C _v (14.4 K _v)	78.0 mm (3.07")	232.0 mm (9.13")

DIMENSIONS

1½" EP PFA, Manual Valve

Side View

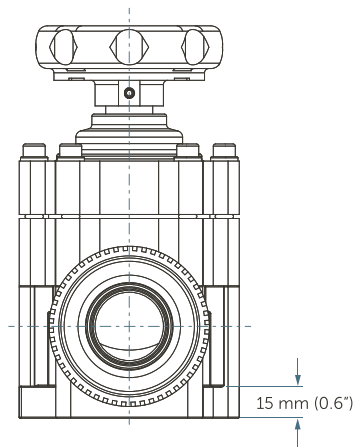

EP PFA 2" Manual Valve

Side View

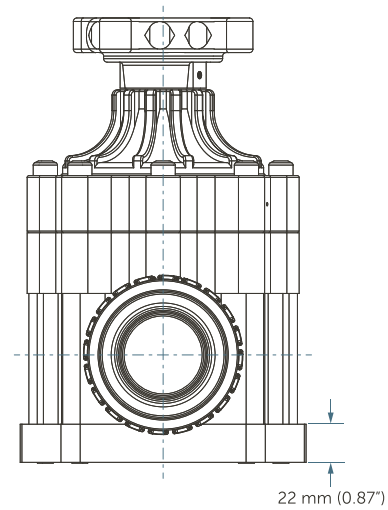

EP PFA 2" Manual Valve

Front View

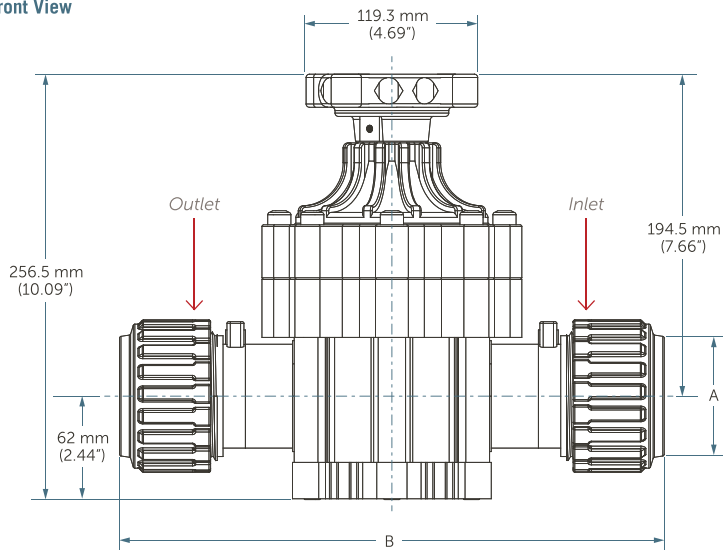

Port connection	Flow factor	Dimensions	
		A	B
1-1/2" PureBond pipe (40A)	38.5 C _v (33.3 K _v)	48.3 mm (1.90")	220.0 mm (8.66")
2" PureBond pipe (50A)	49.1 C _v (42.5 K _v)	60.3 mm (2.37")	220.0 mm (8.66")
2" EP PFA flare	42.3 C _v (36.6 K _v)	95.0 mm (3.74")	329.0 mm (12.9")

ORDERING INFORMATION

PART NUMBER	PORT CONNECTION	FASTENERS
PLMV-F24	1 1/2" EP PFA Flare	Stainless steel
PLMV-F32-C	2" EP PFA flare	Coated stainless steel
PLMV-F32-N	2" EP PFA flare	Stainless steel
PLMV-K24	1 1/2" PrimeLock®	Stainless steel
PLMV-KM40	40 mm PrimeLock®	Stainless steel
PLMV-P24	1 1/2" PureBond® pipe (40A)	Stainless steel
PLMV-P24-C	1 1/2" PureBond® pipe (40A)	Coated stainless steel
PLMV-P32	2" PureBond® pipe (50A)	Stainless steel
PLMV-P32-C	2" PureBond® pipe (50A)	Coated stainless steel