

# FaceStation F2

Fusion Multimodal Terminal



Unrivaled  
Face Recognition  
Performance



Best-in-class  
Multimodal Device



Contactless Solution  
for the New Normal



Robust Device Security and  
Data Encryption

**suprema**  
SECURITY & BIOMETRICS



## Unrivalled face recognition performance by Fusion Matching

FaceStation F2 boasts exceptional authentication accuracy achieved by the fusion matching of visual and infrared(IR) face recognition.

\*False Acceptance Rate(FAR) of 1 in 10 billion.



- Suprema's unique algorithm optimizes IR and visual face recognition to produce the industry's best face recognition and anti-spoofing performance
- Proven track record of authentication performance regardless of user ethnicity and face changes powered by deep learning algorithm

## Best-in-class multimodal with various credentials

FaceStation F2 offers a wide range of authentication options including face, mobile access, fingerprint and cards.



- Register up to 100,000 users for fingerprints authentication and 50,000 users for face authentication
- Supports dual frequency access cards, NFC and BLE-based Mobile Access Cards
- Template-on-Card allows authentication via biometric data stored in cards

**AI** Deep learning-based AI algorithm applied for live face/fingerprint detection





## Contactless solution for new standards of safety and hygiene

FaceStation F2 meets the needs of the post-pandemic world with remote and contactless solution.

- Detects and limits access of users not wearing masks
- Face recognition of users wearing masks
- Remote user enrollment through profile photo uploads
- Combines with Suprema Thermal Camera to identify users with elevated skin temperature

## Robust device security and data encryption

FaceStation F2 is equipped with security measures to protect user data.

- Highest level of device security including secure booting process
- Encrypts all biometric credentials and personal information



## System Configurations

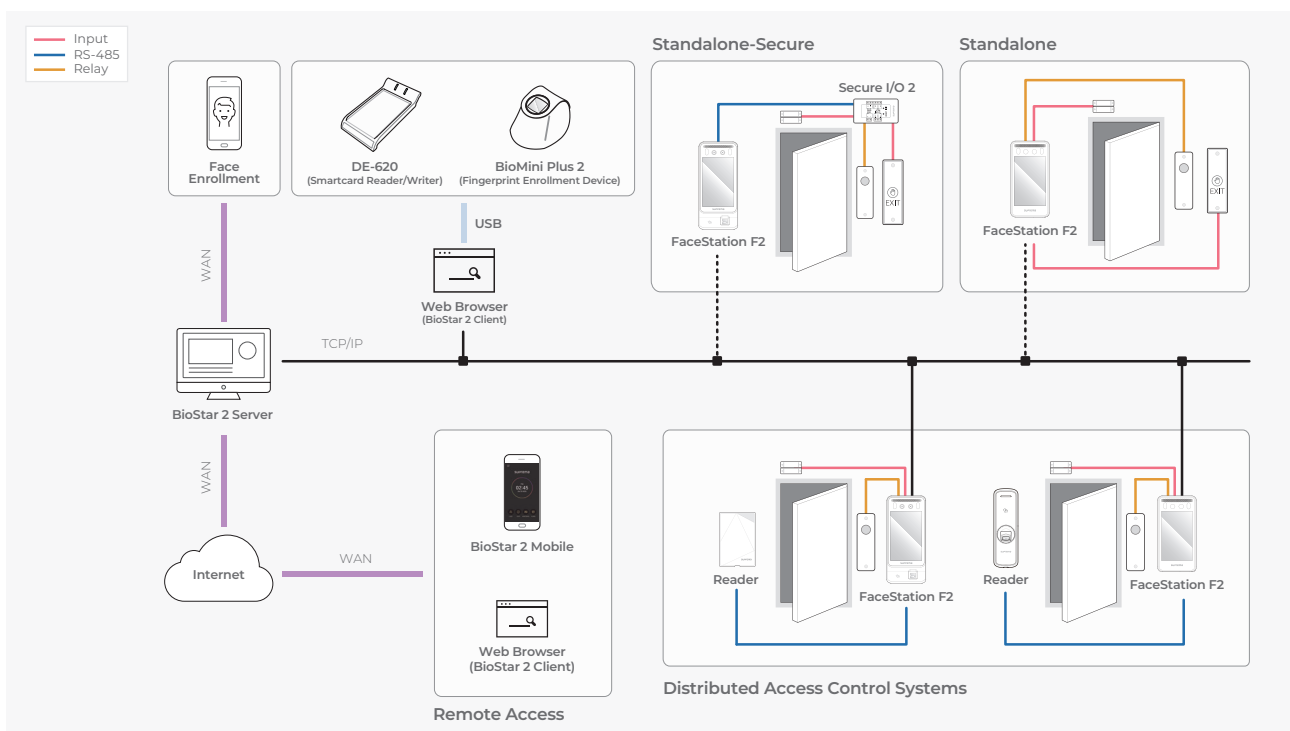

# FaceStation F2

Fusion Multimodal Terminal

## Product Specification



Category	Feature	FSF2-DB	FSF2-AB	FSF2-ODB
Credential	Biometric	Face		Face, Fingerprint
	RF Option	125kHz EM & 13.56MHz MIFARE, MIFARE Plus, DESFire EV1/EV2/EV3 <sup>(1)</sup> , FeliCa	125kHz EM, HID Prox & 13.56MHz MIFARE, MIFARE Plus, DESFire EV1/EV2/EV3 <sup>(1)</sup> , FeliCa, iCLASS SE/SR/Seos	125kHz EM & 13.56MHz MIFARE, MIFARE Plus, DESFire EV1/EV2/EV3 <sup>(1)</sup> , FeliCa
	RF Read Range <sup>(2)</sup>	EM/MIFARE/DESFire : 50 mm (2"), FeliCa: 30 mm (1.2")		
	Mobile	NFC, BLE		
General	CPU	1.8 GHz Dual Core + 1.4 GHz Quad Core		
	Memory	16GB Flash + 2GB RAM		
	Crypto Chip	Supported		
	LCD Type	7" IPS color LCD		
	LCD Resolution	800 x 1280 pixels		
	Sound	16 bit		
	Operating Temperature	-20°C ~ 50°C (-4°F ~ 122°F)		
	Operating Humidity	0% ~ 80%, non-condensing		
	Dimension (W x H x D, mm)	119.8 x 233 x 23.5 (4.7" x 9.1" x 0.9")		119.8 x 268.3 x 49.6 (4.7" x 10.5" x 1.9")
	Weight	Device	585g	670g
		Bracket (Including washer and bolt)	181g	205g
	Ingress Protection (IP)	IP65		
	Certificates	CE, FCC, KC, RoHS, REACH, WEEE		
Face	Recognition Distance	0.5m ~ 1.3m (19.7" ~ 51.2")		
	Recognition Height	140cm ~ 190cm (55.1" ~ 74.8")		
	Matching Speed	Less than 0.5 sec		
	Live Face Detection (Anti-Spoofing)	Supported		
Fingerprint	Image Dimension	N/A		300 x 400 pixels
	Resolution			500 dpi
	Template			SUPREMA / ISO19794-2, ANSI-378
	Extractor / Matcher			MINEX certified and compliant
	Sensor Certificates			FBI PIV and FBI Mobile ID FAP20
	Live Fingerprint Detection			Supported (SW-based)
Capacity	Max. User (1:1) * Based on one face/fingerprint enrollment per user	100,000		
	Max. User (1:N) * Based on one face/fingerprint enrollment per user	Face: 50,000		Face: 50,000 Fingerprint: 100,000
	Max. Text Log	5,000,000		
	Max. Image Log	50,000		
Interface	Ethernet	10/100 Mbps, auto MDI/MDI-X		
	RS-485	5ch		
	RS-485 Communication Protocol	OSDP V2 Compliant		
	Wiegand	1ch Input or Output (Selectable)		
	TTL Input	2ch Inputs		
	Relay	1 Relay		
	USB	USB 2.0 (Host)		
	Tamper	Supported		
Power		DC 12V 1.9A, DC 24V 1A * Use a DC 24V 1A adapter. Must follow the product manual when using a DC 12V adapter.		

<sup>(1)</sup> DESFire EV2/EV3 cards are supported by having backward compatibility of DESFire EV1 cards. CSN and smart card functions are compatible with FaceStation F2.

<sup>(2)</sup> RF read range will vary depending on the installation environment.