

Accessories:

Article	Material No.
Inductive conductivity measurement probes with integrated temperature sensor	287410

Construction:	oval spherical cap, streamline-shaped with 8 mm meter flume diameter
Material:	PP (polypropylene)
Dimensions:	39 x 50 mm (Ø * h), (without fixing adapter)
Pressure resistance:	PN = 10 bar at 20° C
Temperature resistance:	max. 90° C
Temperature sensor:	NTC resistor (R25 = 10 kΩ)
Response time of temp. sensor in measuring cell:	approx. 30 s (90 %-value) with VA-sensor
Material of the sensor's protecting tube:	stainless steel, 1.4571
Sealing element:	O-ring, EPDM 281
Connection cable length:	6 m, possible extension with terminal box 288101!
Type of cable:	7-pin special cable
Connection of measuring lead:	sensor side permanent connection device side circular plug



Article	Material No.
Mounting plate for the simple attaching of the housing to the wall Mounting plate for the simple attaching of the housing to the wall	223512
Additional PCB for external zero-potential release and pre-metering expandable as plugable PCB	223552
Interface module for enable signals for connection to additional PCB for decontrol-signals from 12 to 230 V AC/DC	223595
Extension cord incl. appropriate round plug	E99000128

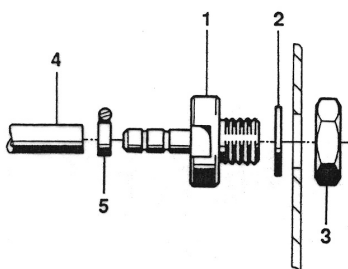

Tank connection straight, stainless steel, to the metering line for textile reinforced hose 6/12 (id/od) and PE-pipe 8/10 (id/od)	240620
---	--------